



Real People. Real Solutions.

February 12, 2025

2025 Mill and Overlay Project

Project Contacts:

Bolton & Menk, Inc.

Matt Bauman, P.E.

City Engineer

952-295-2057

Matthew.Bauman@bolton-menk.com

Kristina Brierley

Design Engineer

612-400-2640

Kristina.Brierley@bolton-menk.com

City of Mound

Ryan Prich

Public Works Director

952-472-0614

Ryanprich@cityofmound.com



Concerns

If there are specific areas of concern within the project area that you would like the design staff to investigate, please reach out to City Engineer Matt Bauman by Friday, March 7, 2025.



Further Information

Additional details about the project on the City's website:

[Engineering & Construction Projects | Mound, MN](#)



Overview

The City of Mound is starting the design phase for the 2025 Mill and Overlay Project. The project includes the following streets:

Sugar Mill Lane
Alwin Circle

Robin Lane
Southview Court

Lady Slipper Circle
Langdon Trail

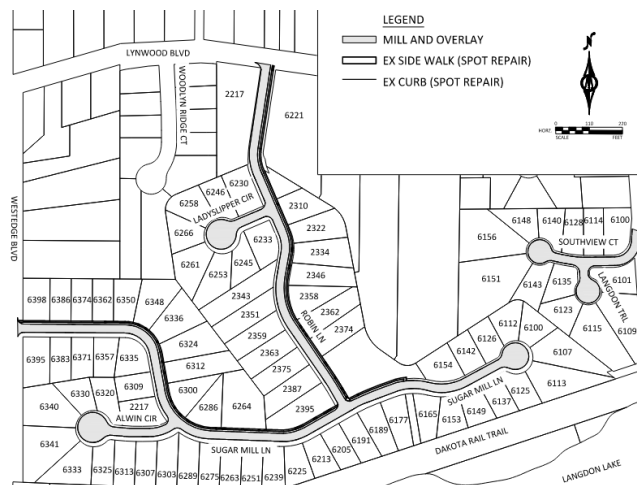

Proposed improvements include:

- Remove several inches of the existing pavement surface and repave
- Limited full depth street patching of failing areas
- Evaluating curbs and performing spot replacement defective areas
- Evaluating sidewalks and performing spot replace defective areas



Schedule

On Tuesday, February 11, 2025, the project was authorized by Mound City Council to finalize the project scope and design. The project is projected to go out for bid later this spring. Construction is planned for this summer and completed in the fall.